

CAUTION: Use of manual tools recommended. When using power tools, adjust to lowest torque setting.

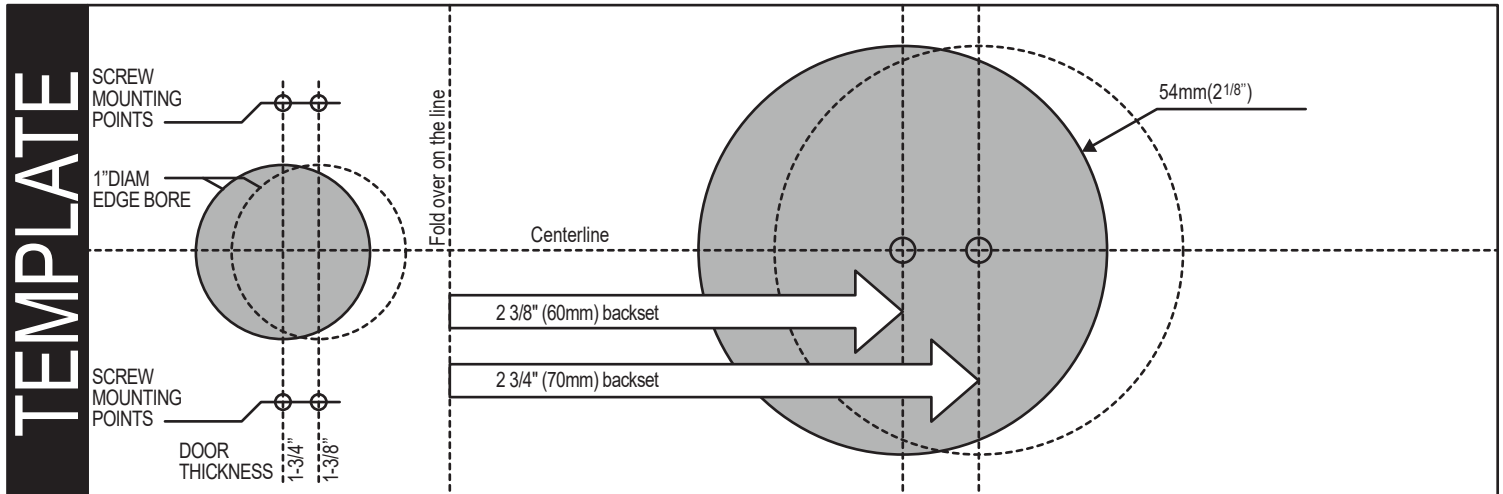

TOOLS NEEDED



Chisel

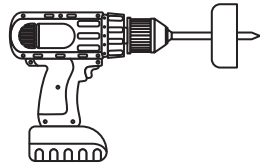

Hand Drill

① NEW DOOR PREPARATION

USE TEMPLATE PROVIDED TO MARK CENTER HOLES ON THE DOOR

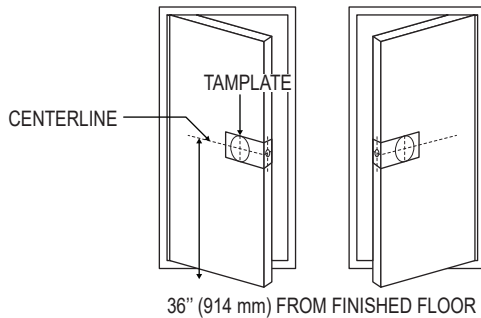

Stand so the door swings towards you. Fold the template over the edge approximately 36" [914mm] from the floor.

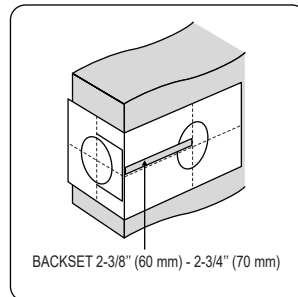

Make a center mark for a 1" [25mm] hole on the door edge and a center mark for a 2-1/8" [54mm] hole on the door surface.

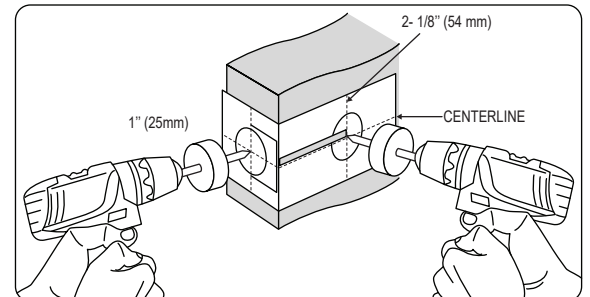

Drill the 2-1/8" [54mm] door surface hole. Drill the 1" [25mm] hole to meet surface hole.

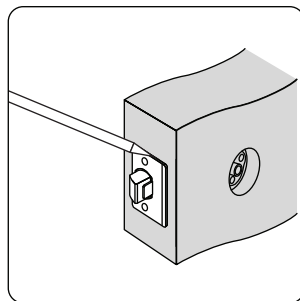

Insert latch in hole and keep it parallel to door face. Mark outline of face plate and remove latch.

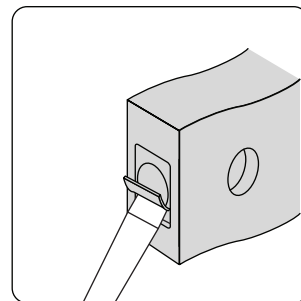

Chisel 1/8" [3mm] deep or Until the plate is flush with the door edge.

② STRIKE PLATE PREPARATION

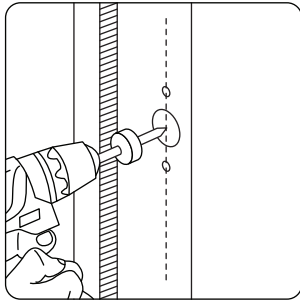

Mark a centerline on the door jamb that aligns with the centerline of the door latch. Drill one 1" [25mm] hole 5/8" [16mm] deep.

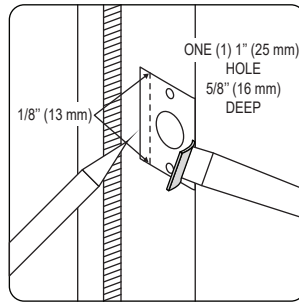

Use the strike plate to make an outline on the door jamb and chisel 1/8" [3mm] deep until it sits flush.

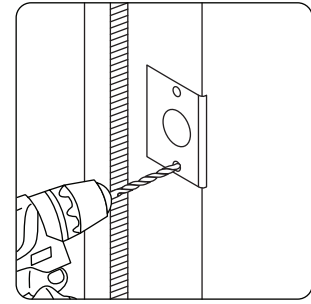

Drill two 1/16 [1.5mm] drill holes and secure the strike plate to the door jamb.

CHANGING LEVER HANDING

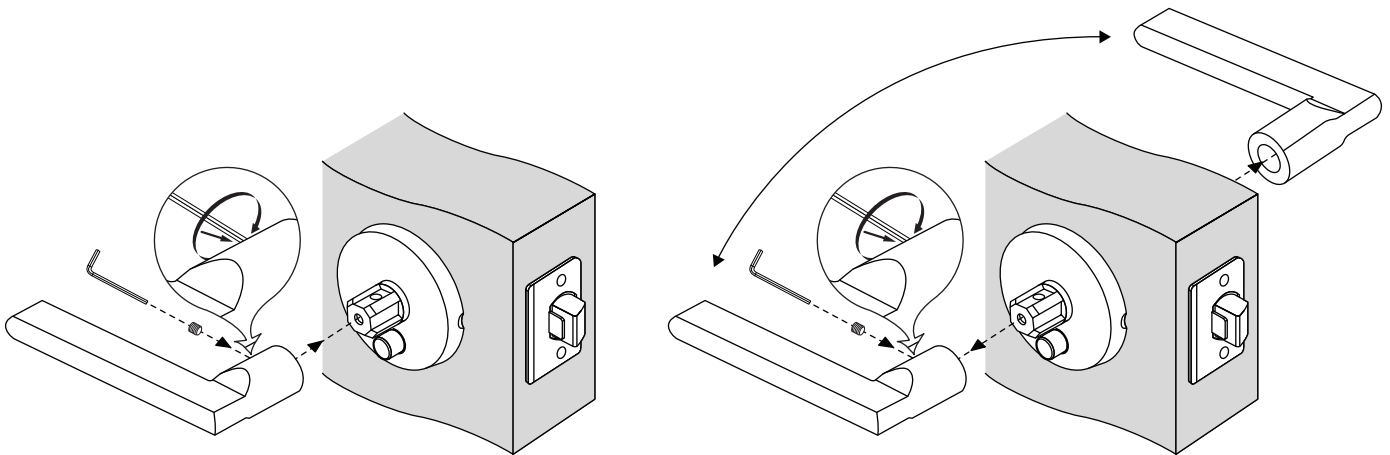

Loosen set screw on the inside of lever using the allen key.

Swap levers. Tighten set screw using the allen key.

CARING FOR YOUR LOCK

Our locksets are polished and then protected with a coating to help prevent tarnishing. This protective coating has limitations and in time may deteriorate from handling, cleaning or exposure to atmospheric conditions such as extreme climate, pollution and proximity to salt water, humidity and ultraviolet rays. Eventual tarnishing is, therefore, not a defect, but a normal process which is unavoidable. With proper care, these products will last a long time.

To care for your lock, wash and clean only with water and polish with a soft clean cloth.

LIFETIME MECHANICAL WARRANTY

Embelle offers a comprehensive warranty program for its products. The Mechanical Limited Warranty covers defects in normal use for as long as the original purchaser occupies the residential premises where the product was installed. The Finish Limited Warranty protects against defects in material and workmanship of the finish for the same period. Warranties do not cover misuse, abuse, scratching, or related costs. To make a claim, the original user must return the defective product to the retailer with proof of purchase, and Embelle will either repair, replace, or refund the product at its discretion.

To view the full warranty, please visit us at www.embellebrand.com/resources.