

·Embelle®



Tafele Lever Handle

4200 series

Tafele Lever Handle

4200 series



SPECIFICATIONS

Lever length	4.65"
Lever projection	2.30"
Lever clearance	1.67"
Rosette height	2.62"
Rosette width	2.62"
Rosette depth	.37"
Face plate	1" X 2-1/4" radius
Finish	Satin Nickel US 15
Function	PRIVACY
Usage	Bedrooms, Bathrooms, Dressing rooms
Concealed screws	Yes
Handing	Reversible for left and right hand use
Area	Interior
Doors	Wooden

FINISHES

US19 Dull Black (DB)

US19 Flat black (FB)

US15 Satin Nickel (SN)

US26 Bright Chrome (BC)

US4 Satin Brass (SB)

Additional finishes available upon request

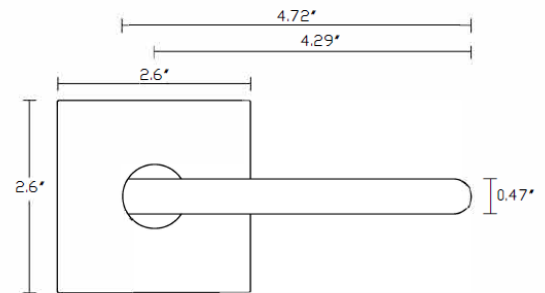
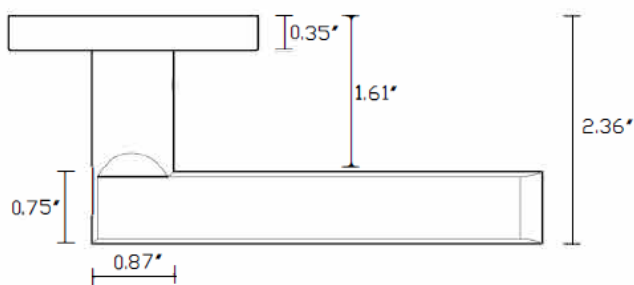

Privacy (R)
Bed & Bath



Passage (A)
Hall & Closet



Dummy (U)
Non-Functional



Entry (N)
Entrance

Embelle®