

EMBER Knob Handle

K200 series

SPECIFICATIONS

Lever length	2.45"
Lever projection	2.84"
Lever clearance	1.45"
Rosette height	2.50"
Rosette width	2.50"
Rosette depth	.39"
Face plate	1" x 2-1/4" radius
Concealed screws	Dummies are concealed
Handing	Reversible for left and right hand use
Area	Interior
Doors	Wooden. Metal door option meets or exceeds ANSI A156.2
ANSI	



FINISHES

US15 Satin Nickel	US26 Polished Chrome
US4 Satin Brass	US15 Satin Nickel
US19 Matte Black	

Additional finishes available upon request

ROSETTE

Square	(Q)
Round	(D)
Rectangle	(G)

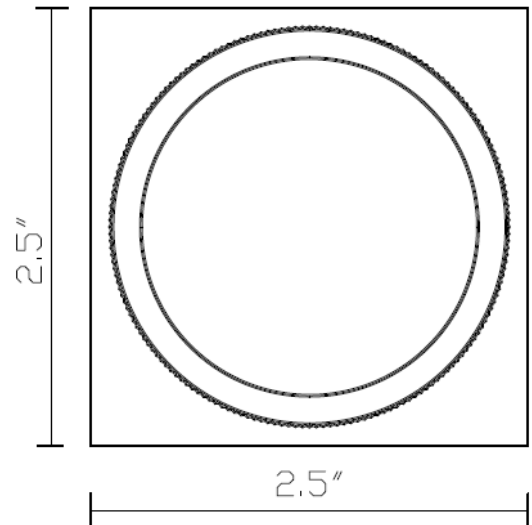
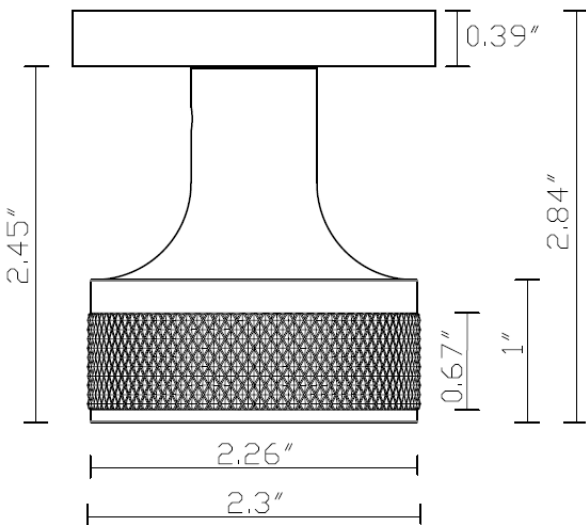

Privacy (R)
Bed & Bath



Passage (A)
Hall & Closet



Dummy (U)
Non-Functional



Entry (N)
Entrance

Embelle®